

The Great Grid Upgrade

Sea Link

Sea Link

Volume 2: Plans and Drawings

Document 2.3: Land Plans Part 1 of 2

Planning Inspectorate Reference: EN020026

Version: E
February 2026

Infrastructure Planning (Applications: Prescribed Forms and Procedure)
Regulations 2009 Regulation 5(2)(i)

nationalgrid

Page intentionally left blank

Version History

Date	Version	Status	Description / Changes
March 2025	A	Final	For DCO submission
October 2025	B	Final	Updated due to Errata
November 2025	C	Final	Updated to change some permanent compounds to temporary; Also update to plot number Errata.
November 2025	C (v2)	Final	Updates submitted as part of the change request.
January 2026	D	Final	Updates submitted as part of the data refresh
February 2026	E	Final	Updated following issues raised at CA Hearing 1 in January 2026

Contents Page

2.3.1 Land Plans - Suffolk **1**

2.3.2 Land Plans - Kent 9



2.3.1 Land Plans - Suffolk





THE NATIONAL GRID (SEA LINK) ORDER
PINS APPLICATION NUMBER: EN020026
LAND PLANS - SUFFOLK
REGULATION 5(2)(i)-(iii)
KEY PLAN 1 OF 1
IN THE DISTRICT OF EAST SUFFOLK DISTRICT COUNCIL

Legend

-  Order Limits
-  Illustration of the edge of sheet and each sheet number
-  Local Authority Boundary



Notes

- This plan is scaled at paper size A0, therefore any prints taken at smaller sizes will affect accuracy of the measurement units and should not be scaled against.
- For further information in regard to what the plans are showing, please see 'Guide to the Plans' (Document Ref 2.1)

Coordinate System: British National Grid
Sheet X Centroid Coordinate: 642519 Sheet Y Centroid Coordinate: 260135

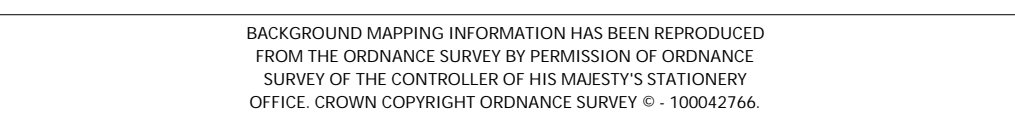

BACKGROUND MAPS INFORMATION HAS BEEN REPRODUCED FROM THE ORDNANCE SURVEY BY PERMISSION OF ORDNANCE SURVEY OF THE CONTROLLER OF HIS MAJESTY'S STATIONERY OFFICE. DESIGNATION ORDNANCE SURVEY © 1000000000

Issue	Date	Remarks	Drawn	Checked	Approved
E	05/02/2026	For Deadline 4	HDA	HKO	LJO
D	07/01/2026	For Deadline 3	HDA	HKO	LJO
C ver 2	21/11/2025	Change Request Version	HDA	ZHU	LJO
C	18/11/2025	For Deadline 1	HDA	DTA	SAN
B	07/10/2025	For Deadline A	HDA	OFO	SAN
A	06/03/2025	For Submission	KGA	DTA	LJO

Title

THE NATIONAL GRID (SEA LINK) ORDER
PINS APPLICATION NUMBER: EN020026
LAND PLANS - SUFFOLK
REGULATION 5(2)(i)-(iii)
KEY PLAN 1 OF 1



Application Number:		EN020026	
National Grid Drawing Reference:			
DCO/SR/PS/0100			
Scale:	Sheet Size:	Sheet:	Issue:
1:12,500	A0	KEY PLAN 1 of 1	E



THE NATIONAL GRID (SEA LINK) ORDER
 PINS APPLICATION NUMBER: EN020026
 LAND PLANS - SUFFOLK
 REGULATION 5(2)(i)-(iii)
 SHEET 1 OF 7
 IN THE DISTRICT OF EAST SUFFOLK DISTRICT COUNCIL

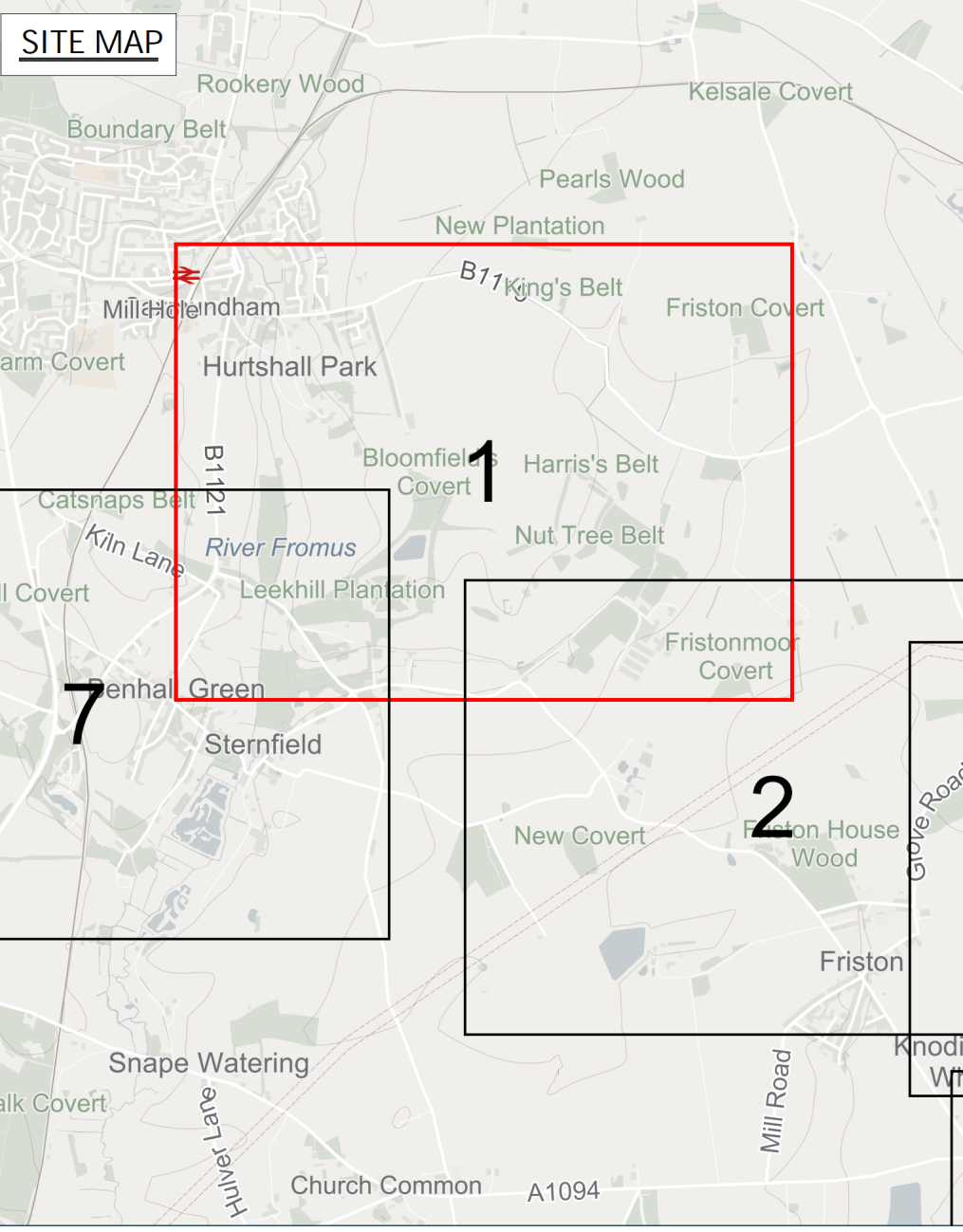

Application Document 2.3.1

Legend

- Order Limits
- Class 1. Compulsory Acquisition of land
- Class 2. Compulsory Acquisition of Rights – Overhead Line
- Class 3. Compulsory Acquisition of Rights – Underground Cable System
- Class 4. Compulsory Acquisition of Rights – Construction Compound
- Class 5. Compulsory Acquisition of Rights – Access
- Class 6. Compulsory Acquisition of Rights – Drainage
- Class 7. Compulsory Acquisition of Rights – Mitigation
- Class 8. Temporary use for Construction, Mitigation, Maintenance, and Demurrals of Redundant Infrastructure
- Class 9. Temporary Use for Access
- Class 10. Land that is not subject to powers of acquisition nor temporary use

Notes

- This plan is scaled at paper size A0, therefore any prints taken at smaller sizes will affect accuracy of the measurement units and should not be scaled against.
- Land Parcels only appear inside the cut lines. Classes extending beyond cut lines do not show land parcel boundaries.
- For further information in regard to what the plans are showing, please see 'Guide to the Plans' (Document Ref 2.1)

Coordinate System: British National Grid
 Sheet X Centroid Coordinate: 679887 Sheet Y Centroid Coordinate: 262330

BACKGROUND MAPPING INFORMATION HAS BEEN REPRODUCED FROM THE OSNAMES SERVICE BY PERMISSION OF OSNAMES. SURVEY OF THE CONTROLLER OF HIS MAJESTY'S STATIONERY OFFICE. DESIGN COPYRIGHT OSNAMES SERVICE © 1999/2004.

Issue	Date	Remarks	Drawn	Checked	Approved
E	10/02/2026	For Deadline 4	ZHU	CFO	LJD
D	08/01/2025	For Deadline 3	BMC	CFO	LJD
C ver 2	21/11/2025	Change Request Version	HDA	ZHU	LJD
C	14/11/2025	For Deadline 1	HDA	ZHU	LJD
B	23/10/2025	For Deadline A	HDA	ZHU	LJD
A	06/03/2025	For Submission	FMA	CFO	LJD

THE NATIONAL GRID (SEA LINK) ORDER
 PINS APPLICATION NUMBER: EN020026
 LAND PLANS - SUFFOLK
 REGULATION 5(2)(i)-(iii)
 SHEET 1 OF 7
 IN THE DISTRICT OF
 EAST SUFFOLK DISTRICT COUNCIL

nationalgrid

Application Number: EN020026
 National Grid Drawing Reference: DCO/SLP/PS/0101

Scale	Sheet Size	Sheet	Issue
1:2,500	A0	SHEET 1 OF 7	E

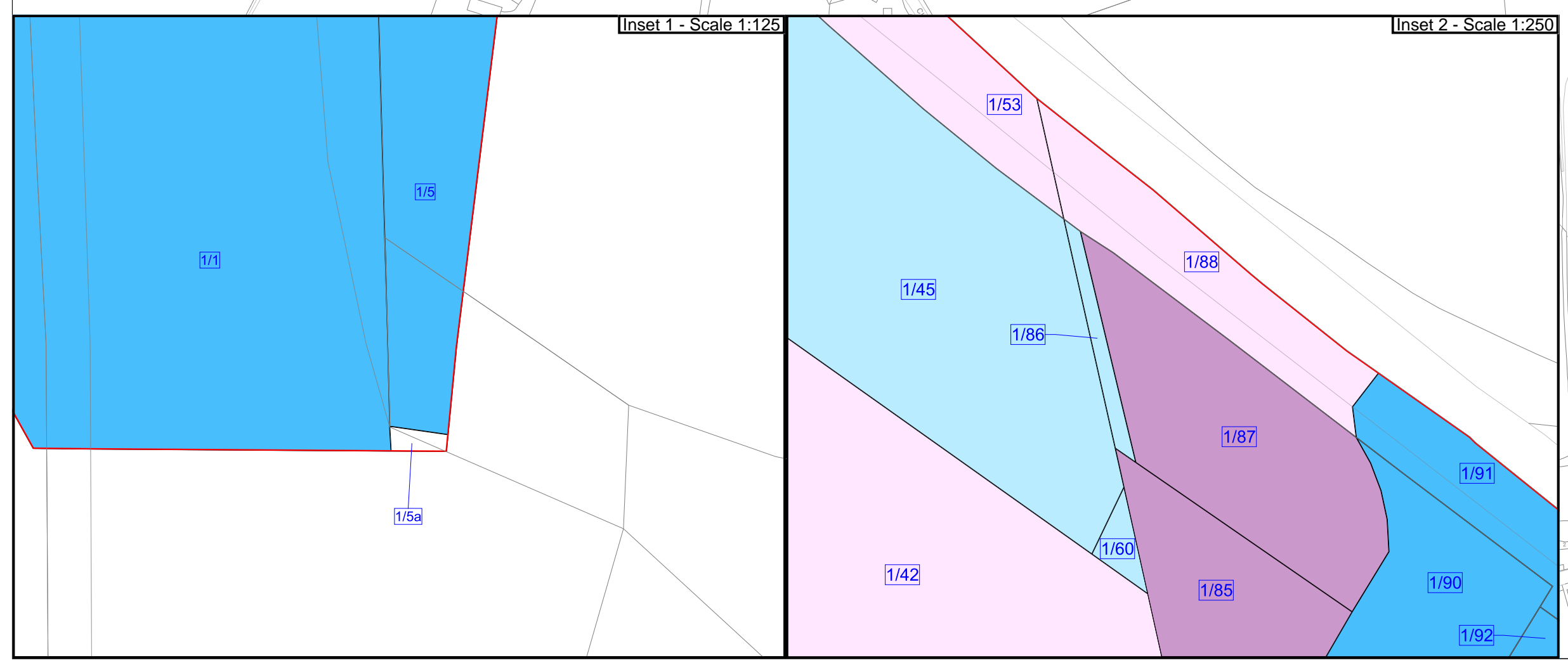
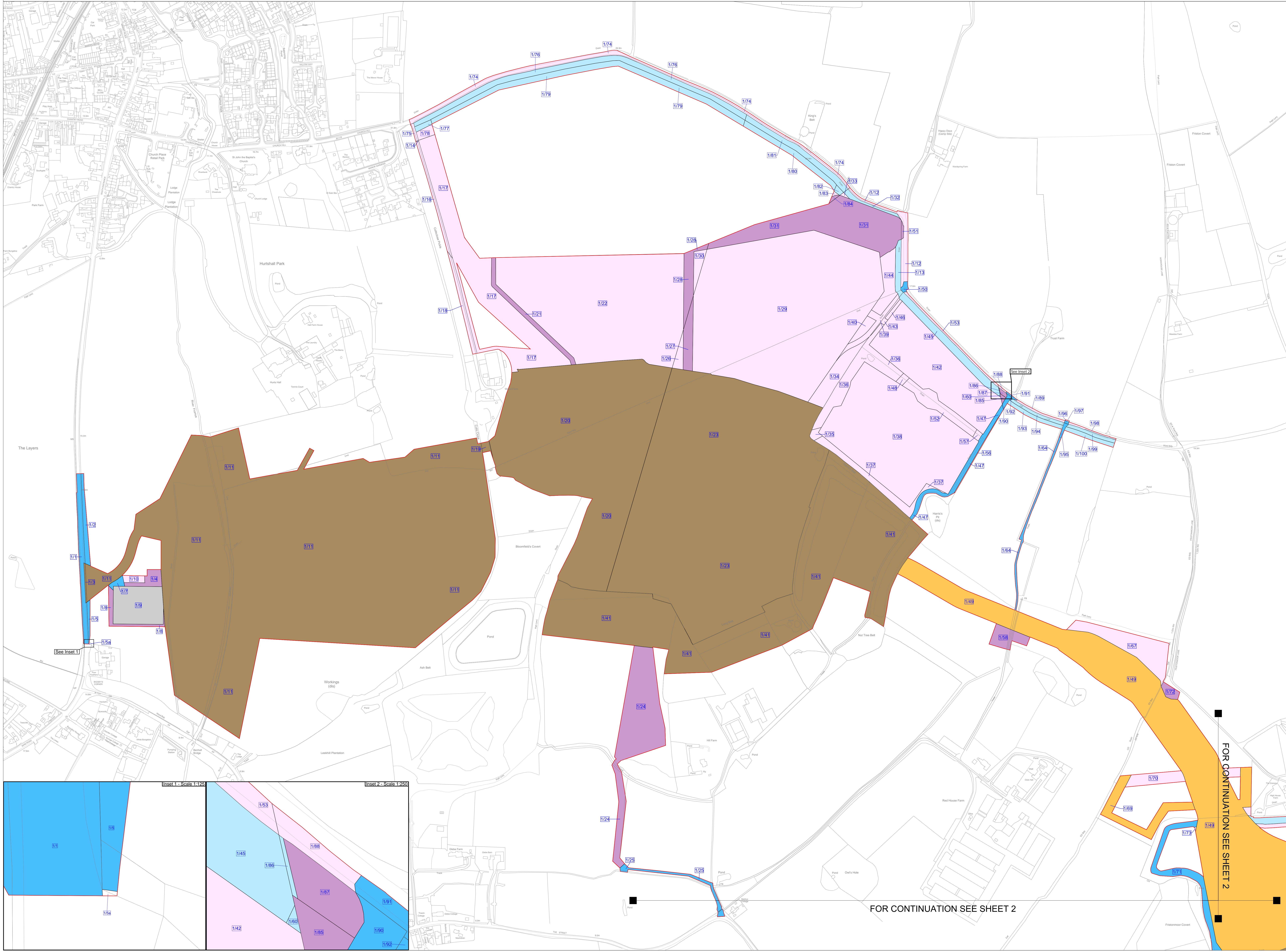



THE NATIONAL GRID (SEA LINK) ORDER
 PINS APPLICATION NUMBER: EN020026
 LAND PLANS - SUFFOLK
 REGULATION 5(2)(i)-(iii)
 SHEET 2 OF 7
 IN THE DISTRICT OF EAST SUFFOLK DISTRICT COUNCIL

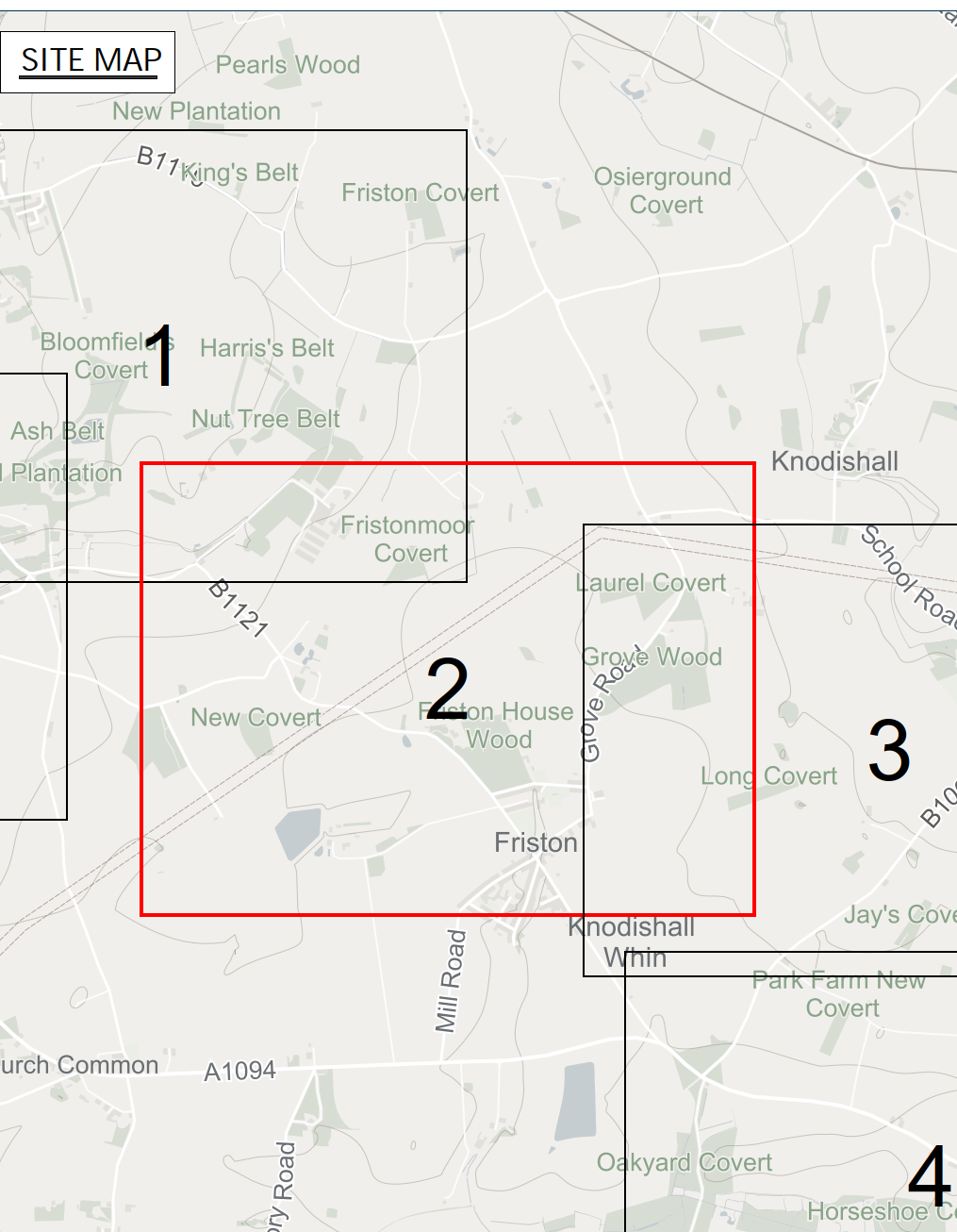

Application Document 2.3.1

- Legend**
- Order Limits
 - Class 1. Compulsory Acquisition of land
 - Class 2. Compulsory Acquisition of Rights - Overhead Line
 - Class 3. Compulsory Acquisition of Rights - Underground Cable System
 - Class 4. Compulsory Acquisition of Rights - Construction Compound
 - Class 5. Compulsory Acquisition of Rights - Access
 - Class 6. Compulsory Acquisition of Rights - Drainage
 - Class 7. Compulsory Acquisition of Rights - Mitigation
 - Class 8. Temporary use for Construction, Mitigation, Maintenance, and Demolition of Redundant Infrastructure
 - Class 9. Temporary Use for Access
 - Class 10. Land that is not subject to powers of acquisition nor temporary use

Notes

1. This plan is scaled at paper size A0, therefore any prints taken at smaller sizes will affect accuracy of the measurement units and should not be scaled against.
2. Land Parcels only appear inside the cut lines. Classes extending beyond cut lines do not show land parcel boundaries.
3. For further information in regard to what the plans are showing please see 'Guide to the Plans' (Document Ref 2.1)

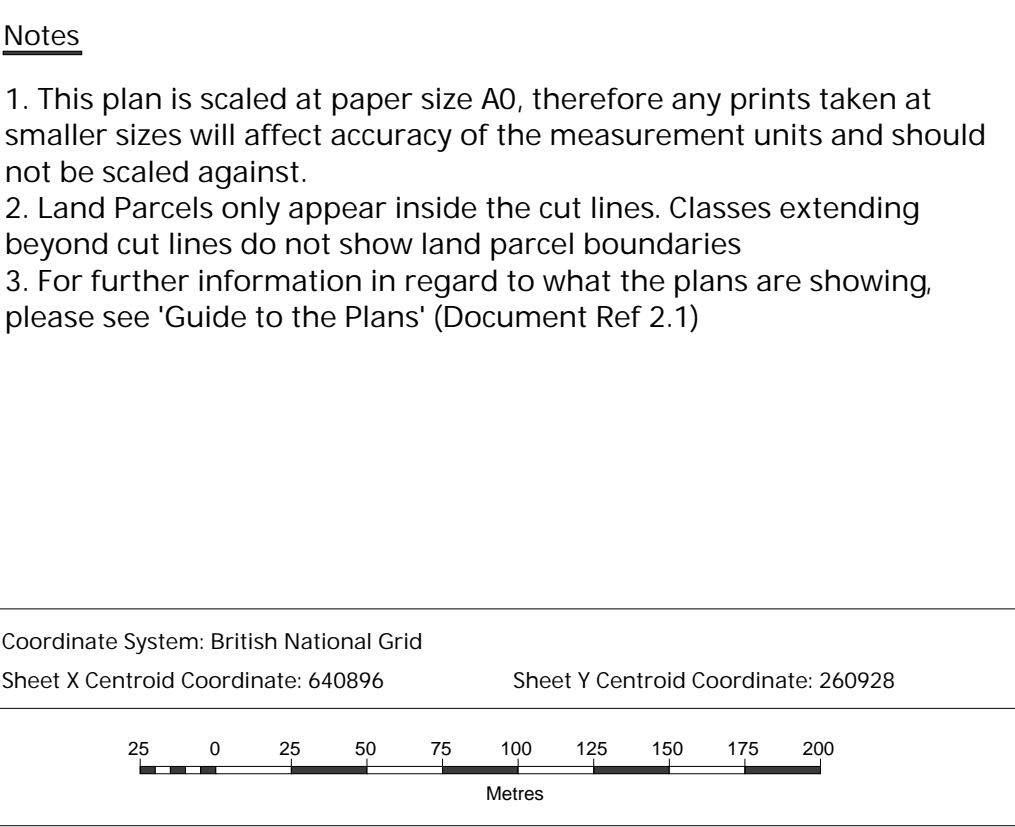

Issue	Date	Remarks	Drawn	Checked	Approved
E	05/02/2026	For Deadline 4	ZHU	HDA	SAN
D	15/01/2026	For Deadline 3	ZHU	HDA	SAN
C ver 2	21/11/2025	Change Request Version	HDA	ZHU	LJO
C	14/11/2025	For Deadline 1	HDA	ZHU	LJO
B	23/10/2025	For Deadline A	HDA	ZHU	LJO
A	06/03/2025	For Submission	KGA	ZHU	SAN

Title

THE NATIONAL GRID (SEA LINK) ORDER
 PINS APPLICATION NUMBER: EN020026
 LAND PLANS - SUFFOLK
 REGULATION 5(2)(i)-(iii)
 SHEET 2 OF 7
 IN THE DISTRICT OF
 EAST SUFFOLK DISTRICT COUNCIL

nationalgrid

Application Number: EN020026
 National Grid Drawing Reference: DCO/SL/PPS/0102

Scale	Sheet Size	Sheet	Issue
1:2,500	A0	SHEET 2 OF 7	E

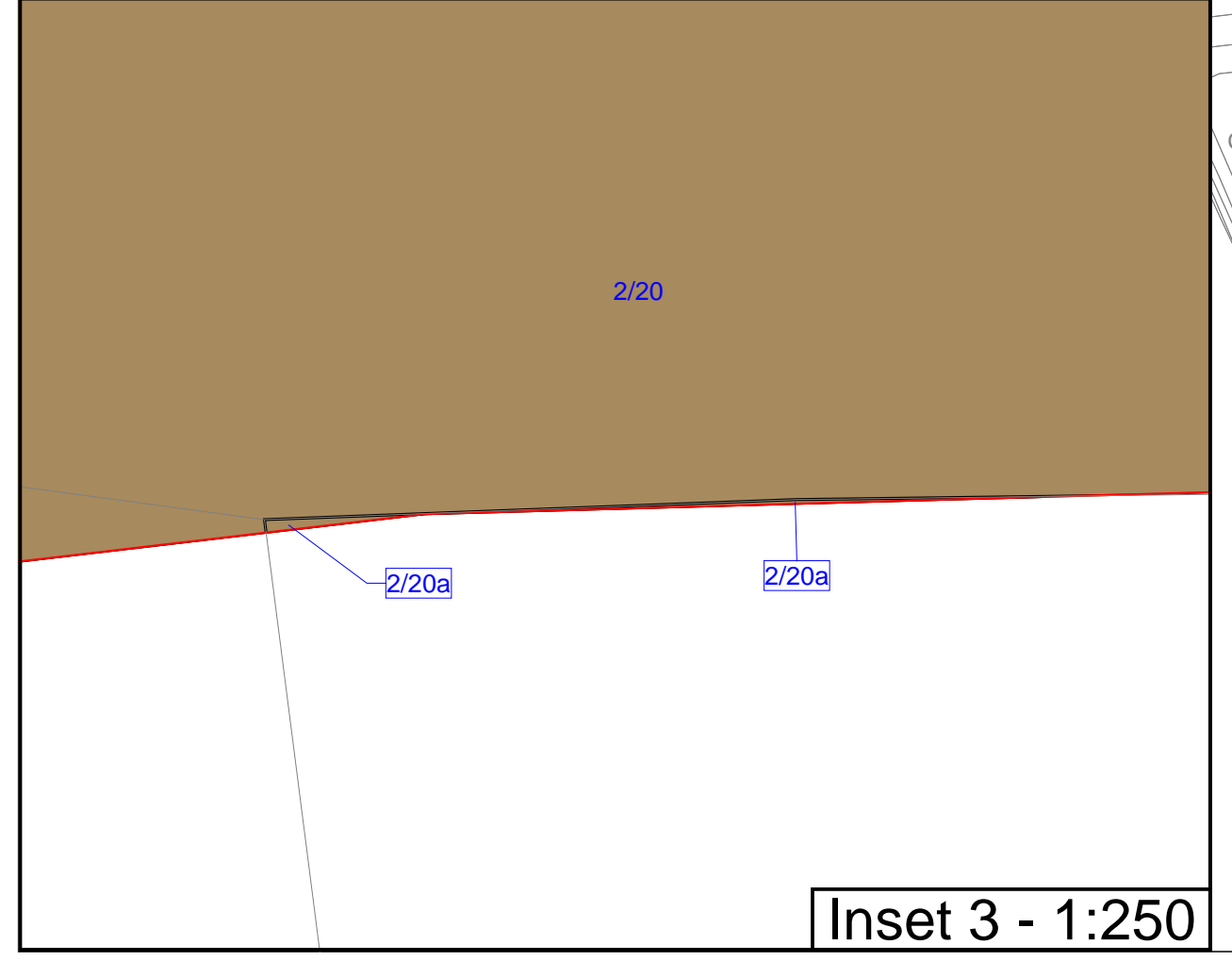
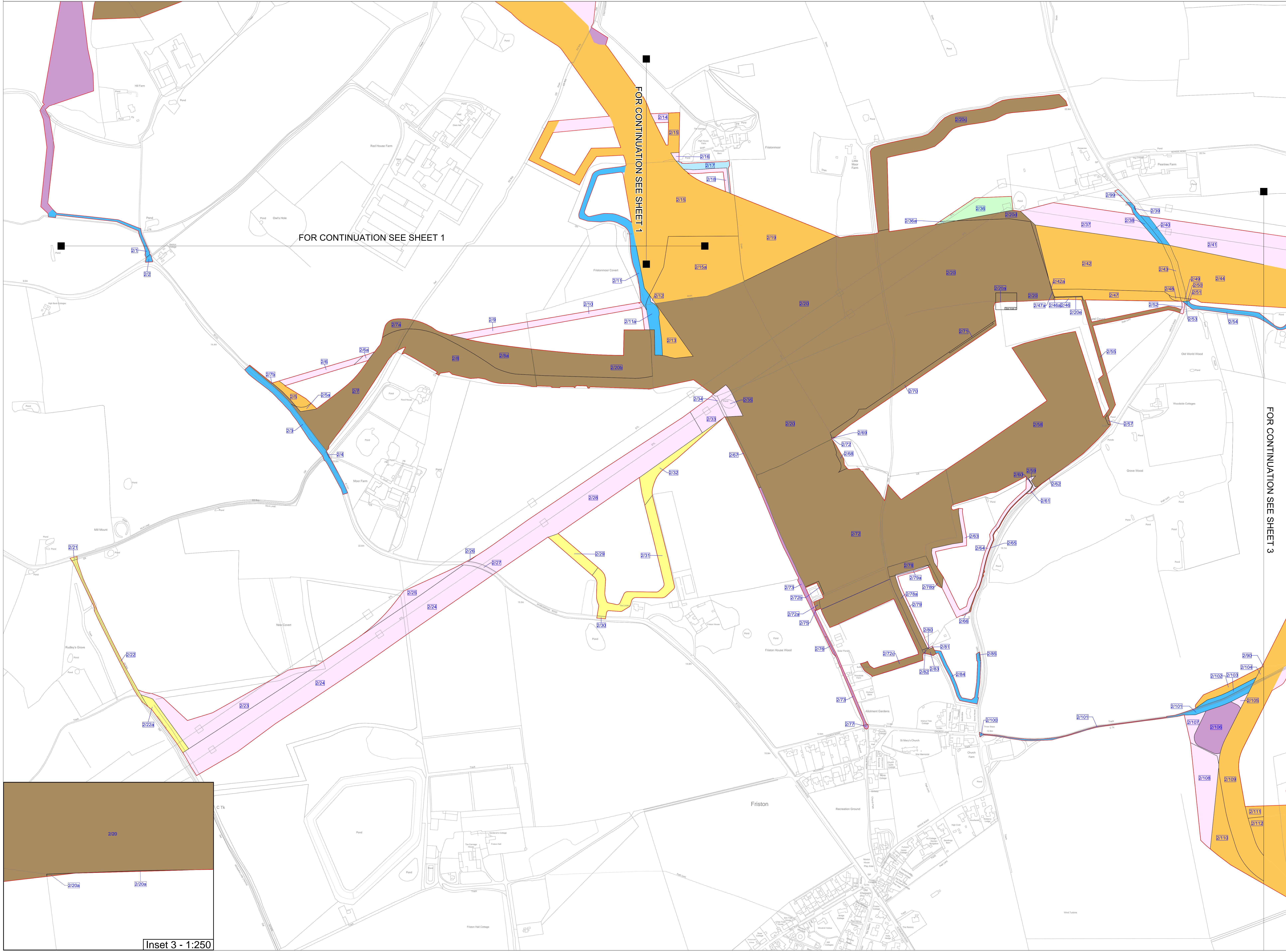

COPYRIGHT: NOT TO BE REPRODUCED WITHOUT THE WRITTEN PERMISSION OF NATIONAL GRID ELECTRICITY TRANSMISSION PLC



THE NATIONAL GRID (SEA LINK) ORDER
 PINS APPLICATION NUMBER: EN020026
 LAND PLANS - SUFFOLK
 REGULATION 5(2)(i)-(iii)
 SHEET 3 OF 7
 IN THE DISTRICT OF EAST SUFFOLK DISTRICT COUNCIL

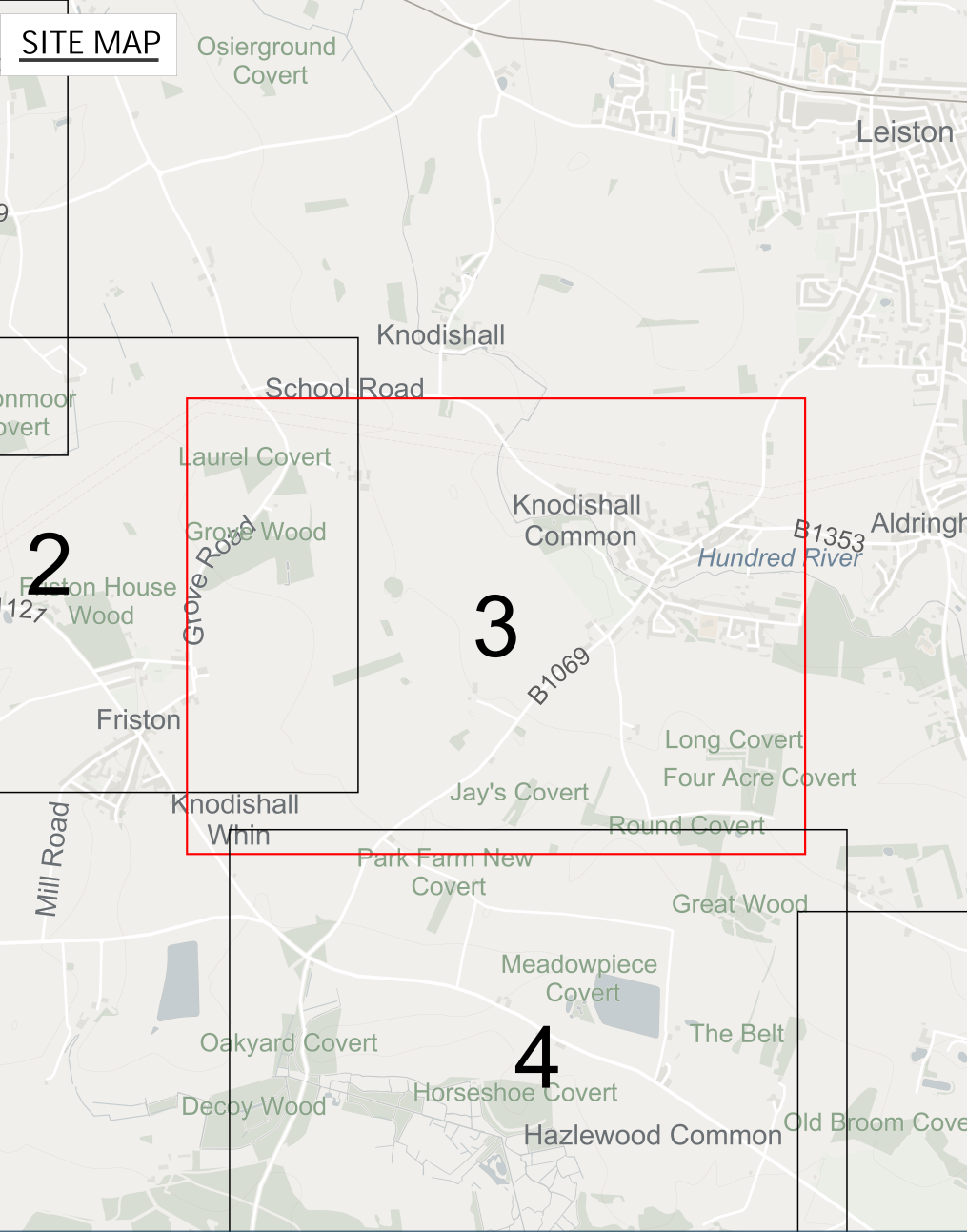

Application Document 2.3.1

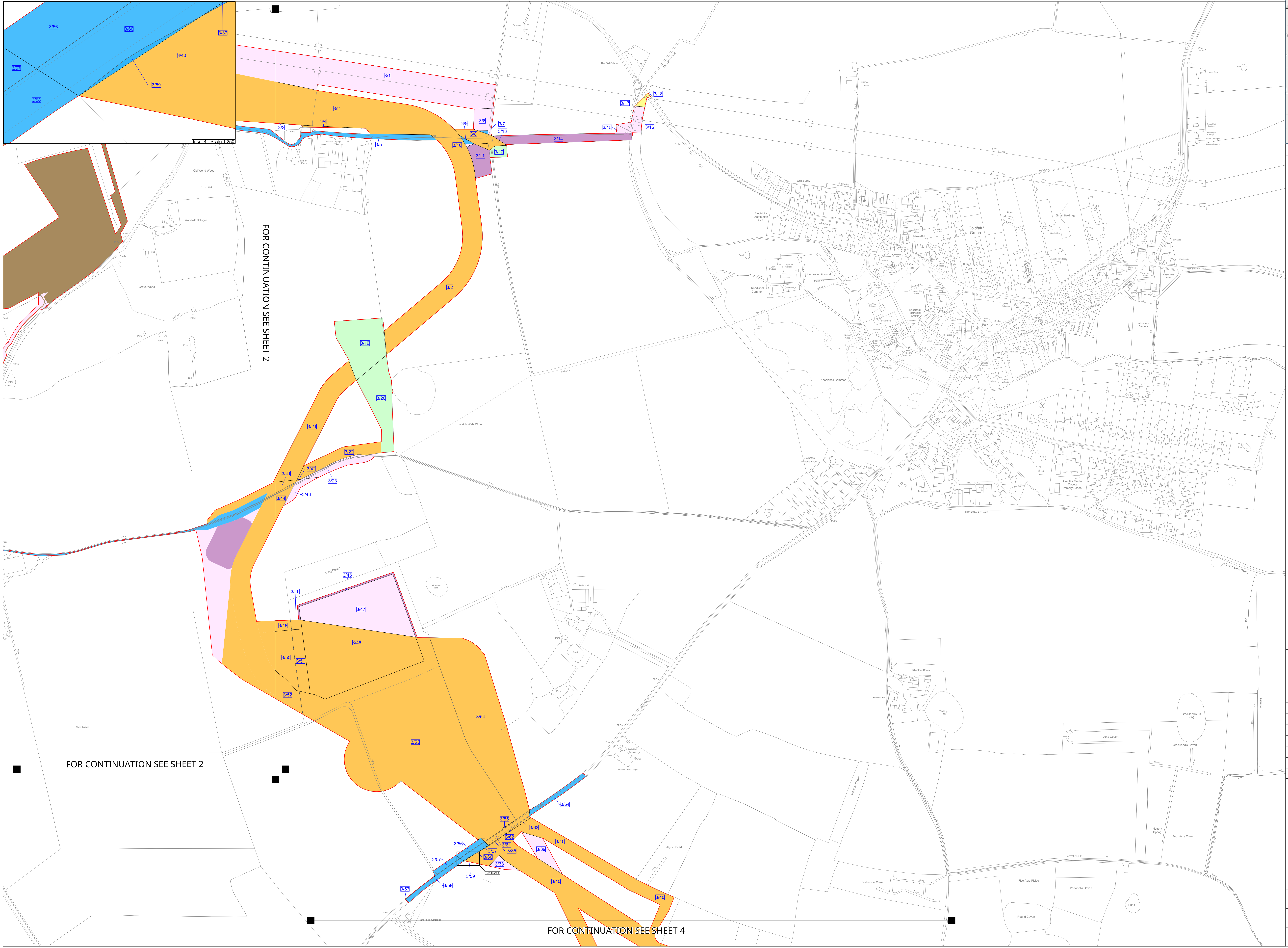

Inset 4 - Scale 1:250

FOR CONTINUATION SEE SHEET 2

FOR CONTINUATION SEE SHEET 2

FOR CONTINUATION SEE SHEET 4

Legend

- Order Limits
- Class 1. Compulsory Acquisition of land
- Class 2. Compulsory Acquisition of Rights - Overhead Line
- Class 3. Compulsory Acquisition of Rights - Underground Cable System
- Class 4. Compulsory Acquisition of Rights - Construction Compound
- Class 5. Compulsory Acquisition of Rights - Access
- Class 6. Compulsory Acquisition of Rights - Drainage
- Class 7. Compulsory Acquisition of Rights - Mitigation
- Class 8. Temporary use for Construction, Mitigation, Maintenance, and Demolition of Redundant Infrastructure
- Class 9. Temporary Use for Access
- Class 10. Land that is not subject to powers of acquisition nor temporary use

- Notes
1. This plan is scaled at paper size A0, therefore any prints taken at smaller sizes will affect accuracy of the measurement units and should not be scaled against.
 2. Land Parcels only appear inside the cut lines. Classes extending beyond cut lines do not show land parcel boundaries.
 3. For further information in regard to what the plans are showing please see 'Guide to the Plans' (Document Ref 2.1)

Coordinate System: British National Grid
 Sheet X Centroid Coordinate: 642735 Sheet Y Centroid Coordinate: 260670

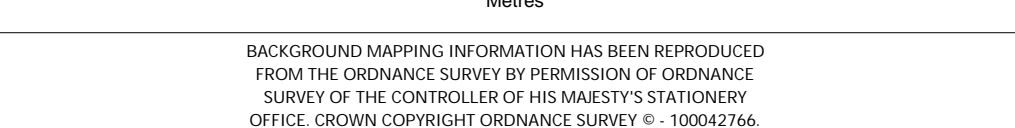

BACKGROUND MAPS INFORMATION HAS BEEN REPRODUCED FROM THE OSNAMES DATA BY PERMISSION OF OSNAMES SURVEY OF THE CONTROLLER OF HIS MAJESTY'S STATIONERY OFFICE. OSNAMES COPYRIGHT OSNAMES SURVEY © 1999/2004.

Issue	Date	Remarks	Drawn	Checked	Approved
E	05/02/2026	For Deadline 4	HDA	HKO	SAN
D	07/01/2026	For Deadline 3	HDA	HKO	SAN
C ver 2	21/11/2025	Change Request Version	HDA	ZHU	LJO
C	14/11/2025	For Deadline 1	HDA	ZHU	LJO
B	23/10/2025	For Deadline A	HDA	ZHU	LJO
A	06/03/2025	For Submission	FMA	ZHU	SAN

THE NATIONAL GRID (SEA LINK) ORDER
 PINS APPLICATION NUMBER: EN020026
 LAND PLANS - SUFFOLK
 REGULATION 5(2)(i)-(iii)
 SHEET 3 OF 7
 IN THE DISTRICT OF
 EAST SUFFOLK DISTRICT COUNCIL



Application Number:	EN020026		
National Grid Drawing Reference:	DCO/SLP/PS/0103		
Scale:	Sheet Size:	Sheet:	Issue:
1:2,500	A0	SHEET 3 OF 7	E



THE NATIONAL GRID (SEA LINK) ORDER
 PINS APPLICATION NUMBER: EN020026
 LAND PLANS - SUFFOLK
 REGULATION 5(2)(i)-(iii)
 SHEET 4 OF 7
 IN THE DISTRICT OF EAST SUFFOLK DISTRICT COUNCIL

FOR CONTINUATION SEE SHEET 3

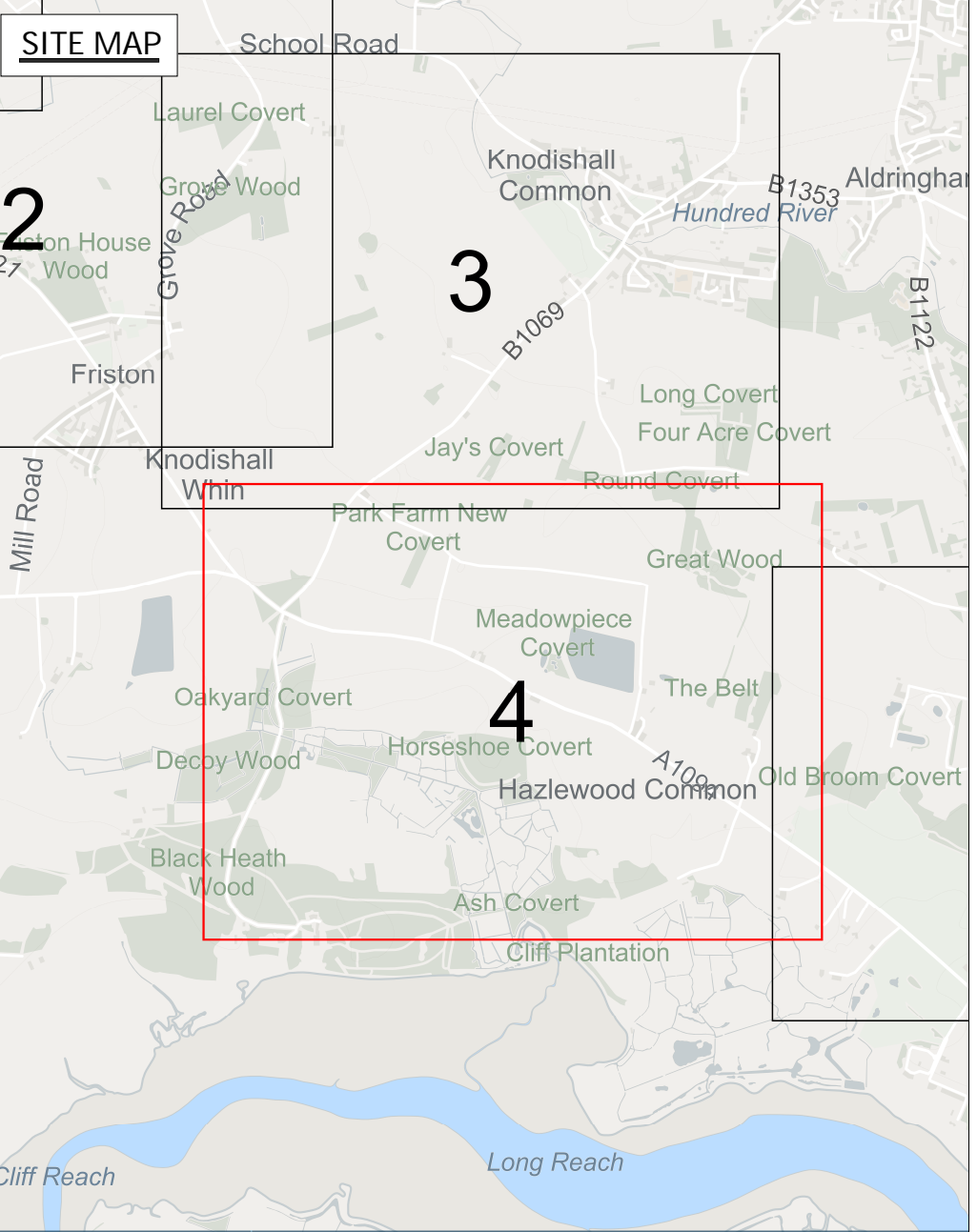

Application Document 2.3.1

Legend

- Order Limits
- Class 1. Compulsory Acquisition of land
- Class 2. Compulsory Acquisition of Rights – Overhead Line
- Class 3. Compulsory Acquisition of Rights – Underground Cable System
- Class 4. Compulsory Acquisition of Rights – Construction Compound
- Class 5. Compulsory Acquisition of Rights – Access
- Class 6. Compulsory Acquisition of Rights – Drainage
- Class 7. Compulsory Acquisition of Rights – Mitigation
- Class 8. Temporary use for Construction, Mitigation, Maintenance, and Demolition of Redundant Infrastructure
- Class 9. Temporary Use for Access
- Class 10. Land that is not subject to powers of acquisition nor temporary use
- Mean High Water Spring (MHWS)
- Mean Low Water Spring (MLWS)

- Notes
1. This plan is scaled at paper size A0, therefore any prints taken at smaller sizes will affect accuracy of the measurement units and should not be scaled against.
 2. Land Parcels only appear inside the cut lines. Classes extending beyond cut lines do not show land parcel boundaries.
 3. For further information in regard to what the plans are showing please see 'Guide to the Plans' (Document Ref 2.1)
 4. Where the MHWS and MLWS coincide at the scale of the plans only the MHWS is shown.

Coordinate System: British National Grid
 Sheet X Centroid Coordinate: 642931 Sheet Y Centroid Coordinate: 258875

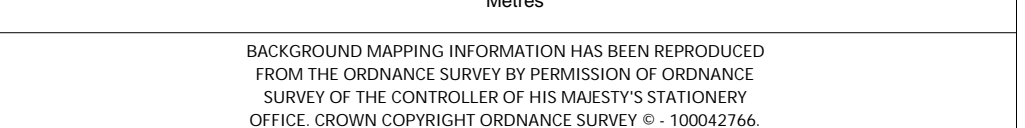

BACKGROUND MAPS INFORMATION HAS BEEN REPRODUCED FROM THE OSNEXUS SOURCE BY PERMISSION OF OSNEXUS SURVEY OF THE CONTROLLER OF HIS MAJESTY'S STATIONERY OFFICE UNDER CORONATION COPYRIGHT 1993.

Issue	Date	Remarks	Drawn	Checked	Approved
E	05/02/2026	For Deadline 4	HDA	HKO	SAN
D	07/01/2026	For Deadline 3	HDA	HKO	SAN
C ver 2	21/11/2025	Change Request Version	HDA	ZHU	LJO
C	14/11/2025	For Deadline 1	ZHU	CFD	LJO
B	23/10/2025	For Deadline A	ZHU	CFD	LJO
A	06/03/2025	For Submission	AKS	CFD	LJO

Title

THE NATIONAL GRID (SEA LINK) ORDER
 PINS APPLICATION NUMBER: EN020026
 LAND PLANS - SUFFOLK
 REGULATION 5(2)(i)-(iii)
 SHEET 4 OF 7
 IN THE DISTRICT OF
 EAST SUFFOLK DISTRICT COUNCIL

nationalgrid

Application Number: EN020026
 National Grid Drawing Reference: DCO/SL/PP/0104
 Scale: 1:2,500 Sheet Size: A0 Sheet: SHEET 4 OF 7 Issue: E

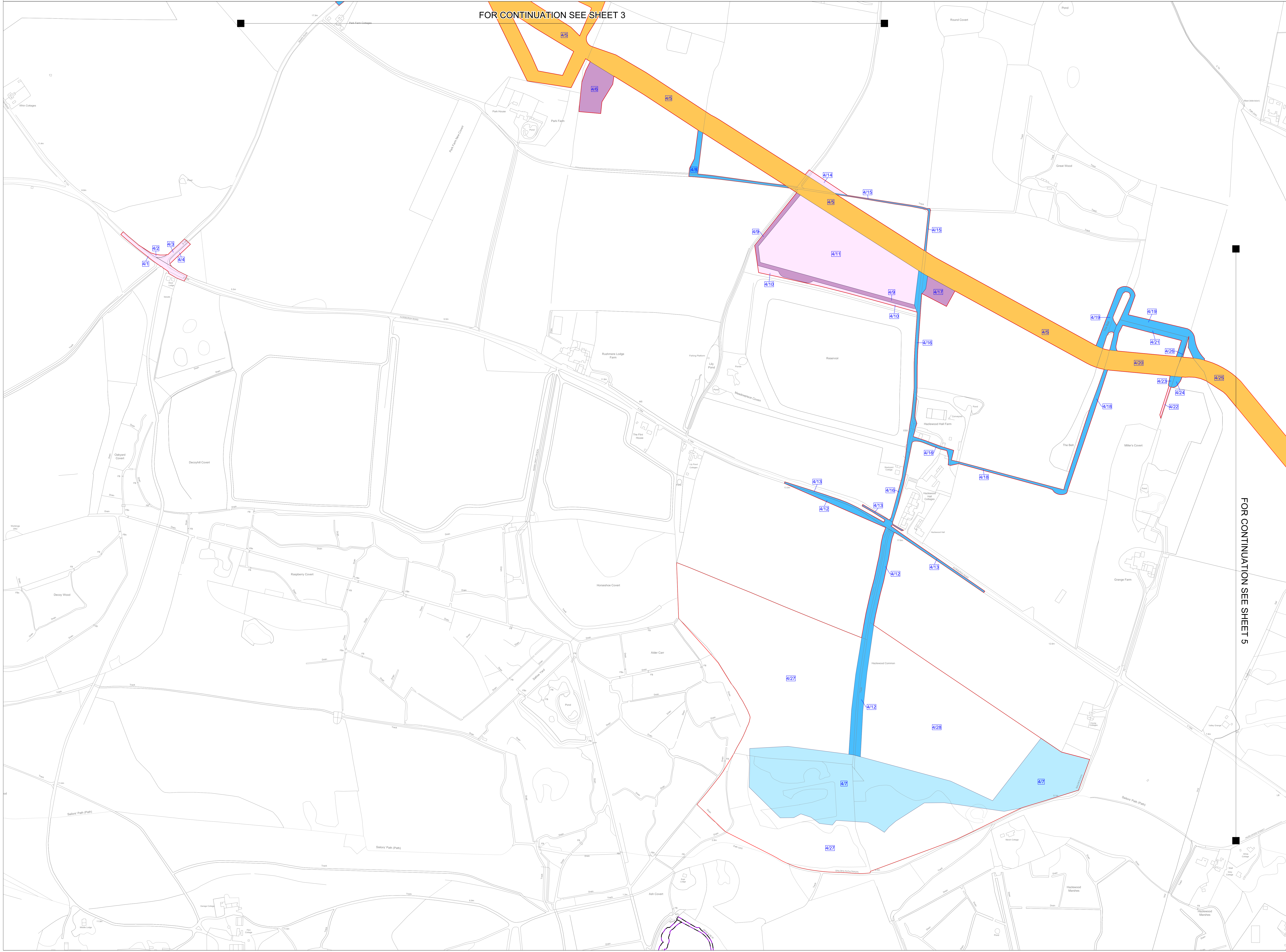

FOR CONTINUATION SEE SHEET 5



THE NATIONAL GRID (SEA LINK) ORDER
 PINS APPLICATION NUMBER: EN020026
 LAND PLANS - SUFFOLK
 REGULATION 5(2)(i)-(iii)
 SHEET 5 OF 7
 IN THE DISTRICT OF EAST SUFFOLK DISTRICT COUNCIL

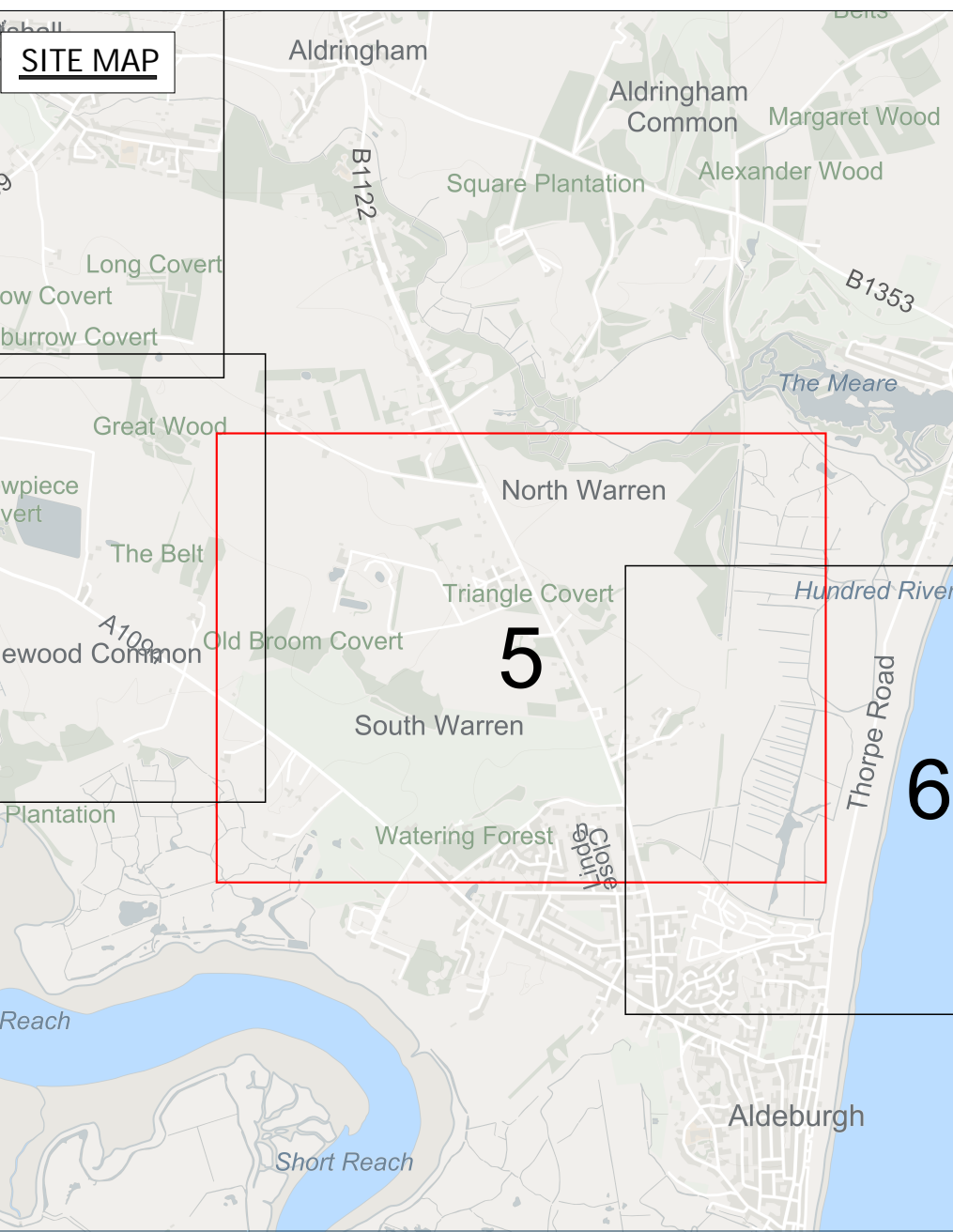

Application Document 2.3.1

Legend

- Order Limits
- Class 1. Compulsory Acquisition of land
- Class 2. Compulsory Acquisition of Rights – Overhead Line
- Class 3. Compulsory Acquisition of Rights – Underground Cable System
- Class 4. Compulsory Acquisition of Rights – Construction Compound
- Class 5. Compulsory Acquisition of Rights – Access
- Class 6. Compulsory Acquisition of Rights – Drainage
- Class 7. Compulsory Acquisition of Rights – Mitigation
- Class 8. Temporary use for Construction, Mitigation, Maintenance, and Demurrage of Redundant Infrastructure
- Class 9. Temporary Use for Access
- Class 10. Land that is not subject to powers of acquisition nor temporary use

- Notes**
1. This plan is scaled at paper size A0, therefore any prints taken at smaller sizes will affect accuracy of the measurement units and should not be scaled against.
 2. Land Parcels only appear inside the cut lines. Classes extending beyond cut lines do not show land parcel boundaries
 3. For further information in regard to what the plans are showing please see 'Guide to the Plans' (Document Ref 2.1)

Coordinate System: British National Grid
 Sheet X Centroid Coordinate: 645296 Sheet Y Centroid Coordinate: 258534

BACKGROUND MAPS AND INFORMATION HAS BEEN REPRODUCED FROM THE OFFICIAL SOURCE OF INFORMATION OF ORIGINARY SURVEY OR THE CONTROLLER OF HIS MAJESTY'S STATIONERY OFFICE. DESIGN COPYRIGHT (C) 2006/07/08/09/10/11/12/13/14/15/16/17/18/19/20/21/22/23/24/25/26/27/28/29/30/31/32/33/34

Issue	Date	Remarks	Drawn	Checked	Approved
E	05/02/2026	For Deadline 4	HDA	HKO	SAN
D	07/01/2026	For Deadline 3	HDA	HKO	SAN
C ver 2	21/11/2025	Change Request Version	HDA	ZHU	LJO
C	14/11/2025	For Deadline 1	MBR	ZHU	LJO
B	23/10/2025	For Deadline A	MBR	ZHU	LJO
A	06/03/2025	For Submission	AJS	CFO	LJO

THE NATIONAL GRID (SEA LINK) ORDER
 PINS APPLICATION NUMBER: EN020026
 LAND PLANS - SUFFOLK
 REGULATION 5(2)(i)-(iii)
 SHEET 5 OF 7
 IN THE DISTRICT OF
 EAST SUFFOLK DISTRICT COUNCIL

nationalgrid

Application Number: EN020026
 National Grid Drawing Reference: DCO/S/PP/0105

Scale	Sheet Size	Sheet	Issue
1:2,500	A0	SHEET 5 OF 7	E

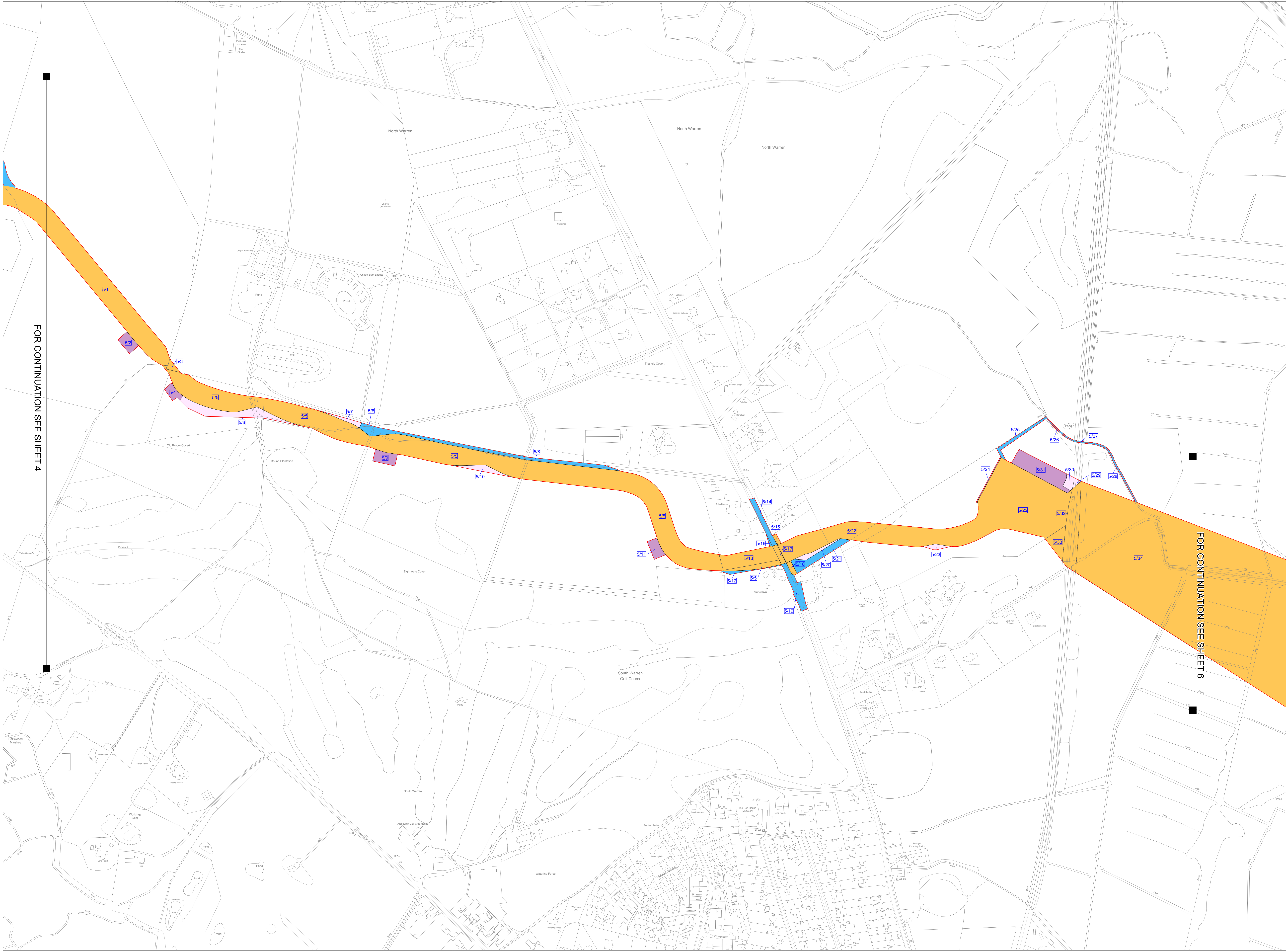

FOR CONTINUATION SEE SHEET 4

FOR CONTINUATION SEE SHEET 6



THE NATIONAL GRID (SEA LINK) ORDER
 PINS APPLICATION NUMBER: EN020026
 LAND PLANS - SUFFOLK
 REGULATION 5(2)(i)-(iii)
 SHEET 6 OF 7
 IN THE DISTRICT OF EAST SUFFOLK DISTRICT COUNCIL

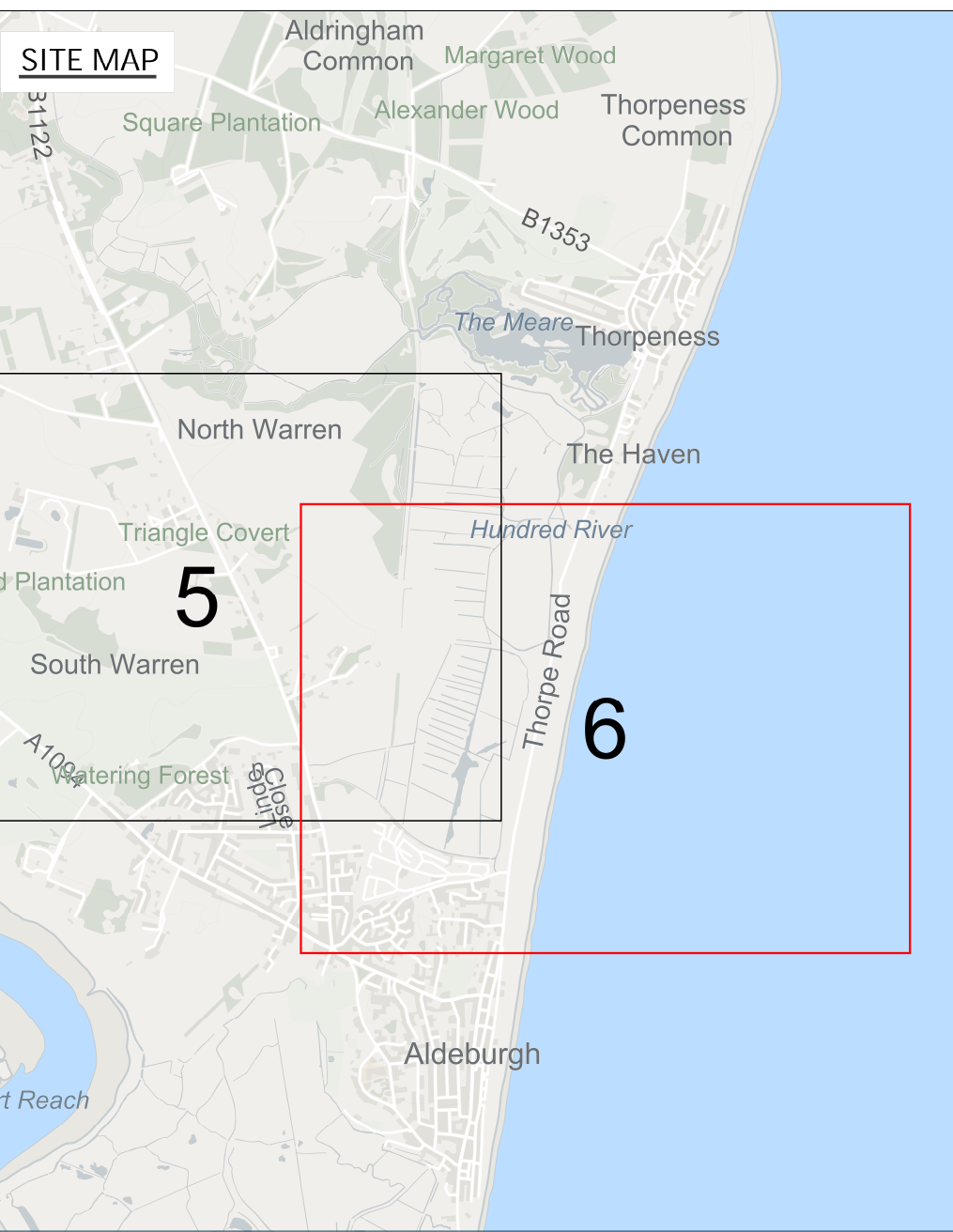

Application Document 2.3.1

Legend

- Order Limits
- Class 1. Compulsory Acquisition of land
- Class 2. Compulsory Acquisition of Rights – Overhead Line
- Class 3. Compulsory Acquisition of Rights – Underground Cable System
- Class 4. Compulsory Acquisition of Rights – Construction Compound
- Class 5. Compulsory Acquisition of Rights – Access
- Class 6. Compulsory Acquisition of Rights – Drainage
- Class 7. Compulsory Acquisition of Rights – Mitigation
- Class 8. Temporary use for Construction, Mitigation, Maintenance, and Demolition of Redundant Infrastructure
- Class 9. Temporary Use for Access
- Class 10. Land that is not subject to powers of acquisition nor temporary use
- Local Authority Boundary
- Mean High Water Spring (MHWS)
- Mean Low Water Spring (MLWS)

Notes

1. This plan is scaled at paper size A0, therefore any prints taken at smaller sizes will affect accuracy of the measurement units and should not be scaled against.
2. Land Parcels only appear inside the cut lines. Classes extending beyond cut lines do not show land parcel boundaries
3. For further information in regard to what the plans are showing, please see 'Guide to the Plans' (Document Ref 2.1)
4. Where the MHWS and MLWS coincide at the scale of the plans only the MHWS is shown.

Coordinate System: British National Grid
 Sheet X Centroid Coordinate: 647021 Sheet Y Centroid Coordinate: 257977

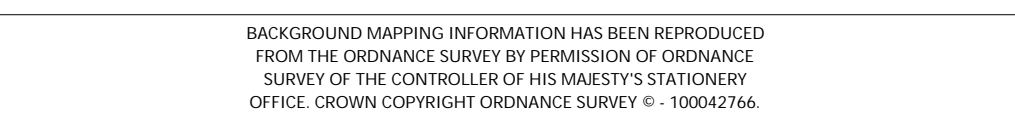

BACKGROUND MAPPING INFORMATION HAS BEEN REPRODUCED FROM THE ORDNANCE SURVEY BY PERMISSION OF ORDNANCE SURVEY OF THE CONTROLLER OF HIS MAJESTY'S STATIONERY OFFICE. ORDNANCE SURVEY ORDNANCE SURVEY © 1999/2004.

Issue	Date	Remarks	Drawn	Checked	Approved
E	05/02/2026	For Deadline 4	HDA	HKO	SAN
D	07/01/2026	For Deadline 3	HDA	HKO	SAN
C ver 2	21/11/2025	Change Request Version	HDA	ZHU	LJO
C	18/11/2025	For Deadline 1	MBR	ZHU	LJO
B	23/10/2025	For Deadline A	MBR	ZHU	LJO
A	06/03/2025	For Submission	AKS	CFO	LJO

Title
 THE NATIONAL GRID (SEA LINK) ORDER
 PINS APPLICATION NUMBER: EN020026
 LAND PLANS - SUFFOLK
 REGULATION 5(2)(i)-(iii)
 SHEET 6 OF 7
 IN THE DISTRICT OF
 EAST SUFFOLK DISTRICT COUNCIL

nationalgrid

Application Number: EN020026
 National Grid Drawing Reference: DCO/SLP/PS/0106

Scale	Sheet Size	Sheet	Issue
1:2,500	A0	SHEET 6 OF 7	E

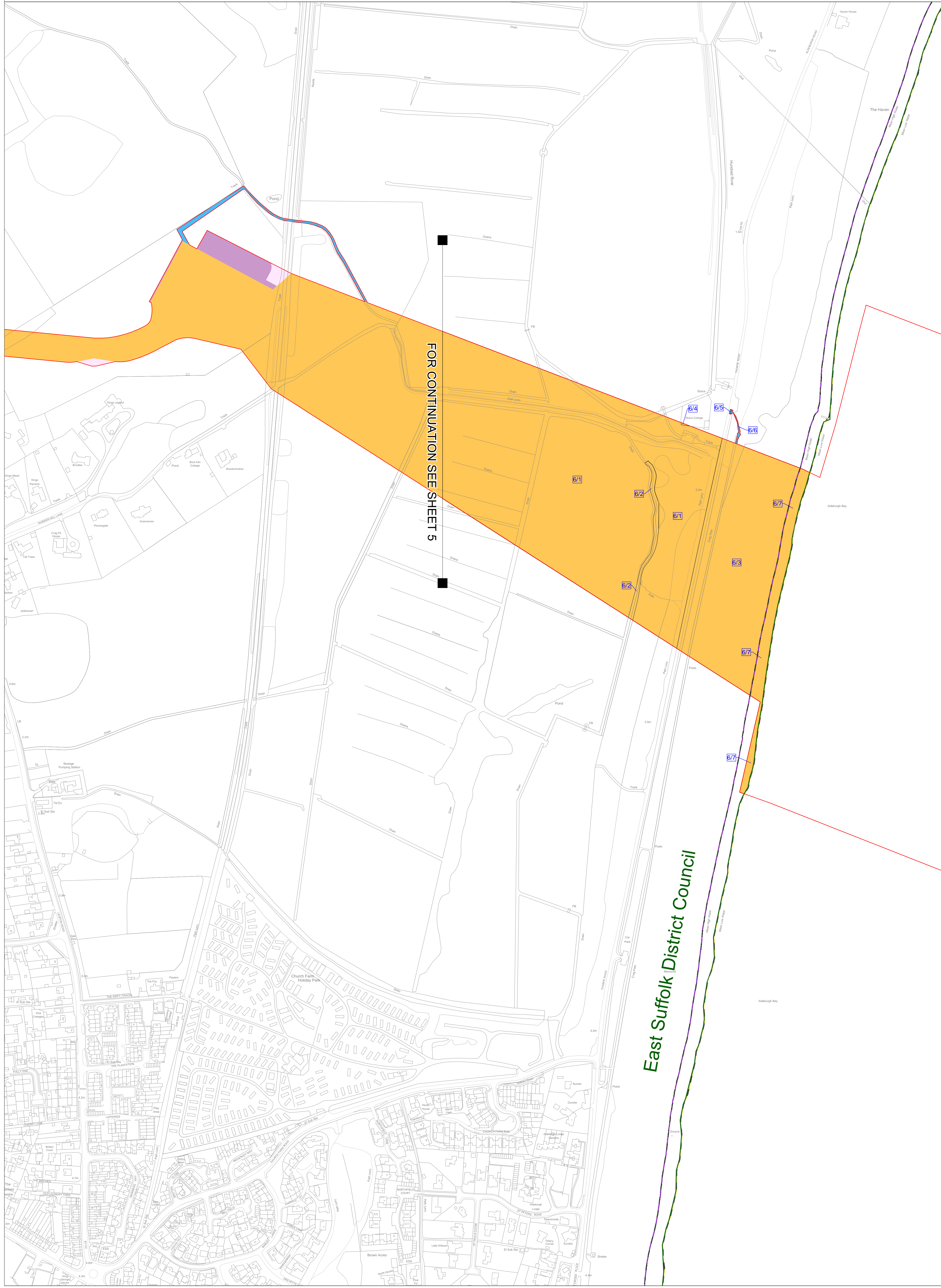



THE NATIONAL GRID (SEA LINK) ORDER
 PINS APPLICATION NUMBER: EN020026
 LAND PLANS - SUFFOLK
 REGULATION 5(2)(i)-(iii)
 SHEET 7 OF 7
 IN THE DISTRICT OF EAST SUFFOLK DISTRICT COUNCIL

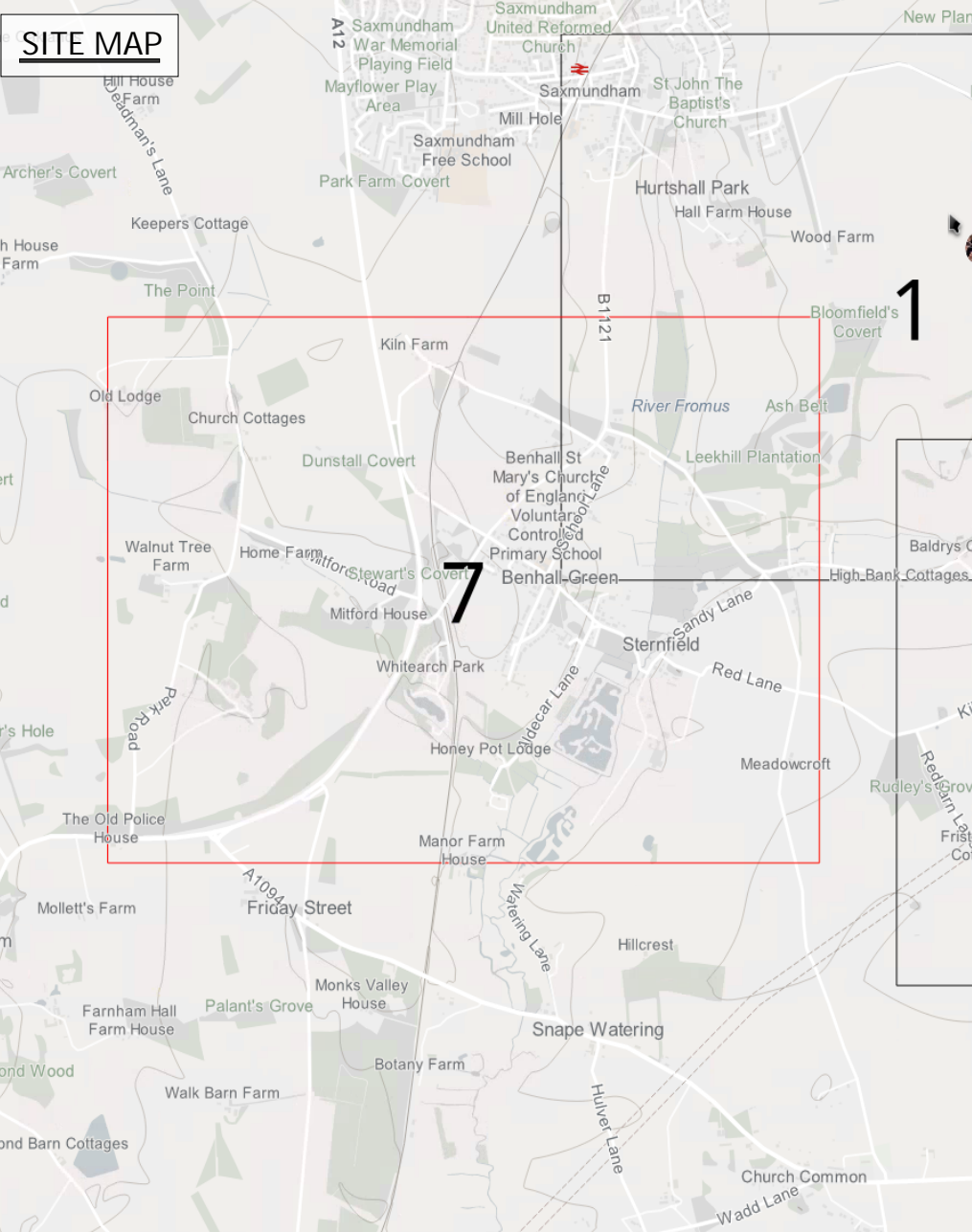

Application Document 2.3.1

- Legend**
- Order Limits
 - Class 1. Compulsory Acquisition of land
 - Class 2. Compulsory Acquisition of Rights - Overhead Line
 - Class 3. Compulsory Acquisition of Rights - Underground Cable System
 - Class 4. Compulsory Acquisition of Rights - Construction Compound
 - Class 5. Compulsory Acquisition of Rights - Access
 - Class 6. Compulsory Acquisition of Rights - Drainage
 - Class 7. Compulsory Acquisition of Rights - Mitigation
 - Class 8. Temporary use for Construction, Mitigation, Maintenance, and Demolition of Redundant Infrastructure
 - Class 9. Temporary Use for Access
 - Class 10. Land that is not subject to powers of acquisition nor temporary use

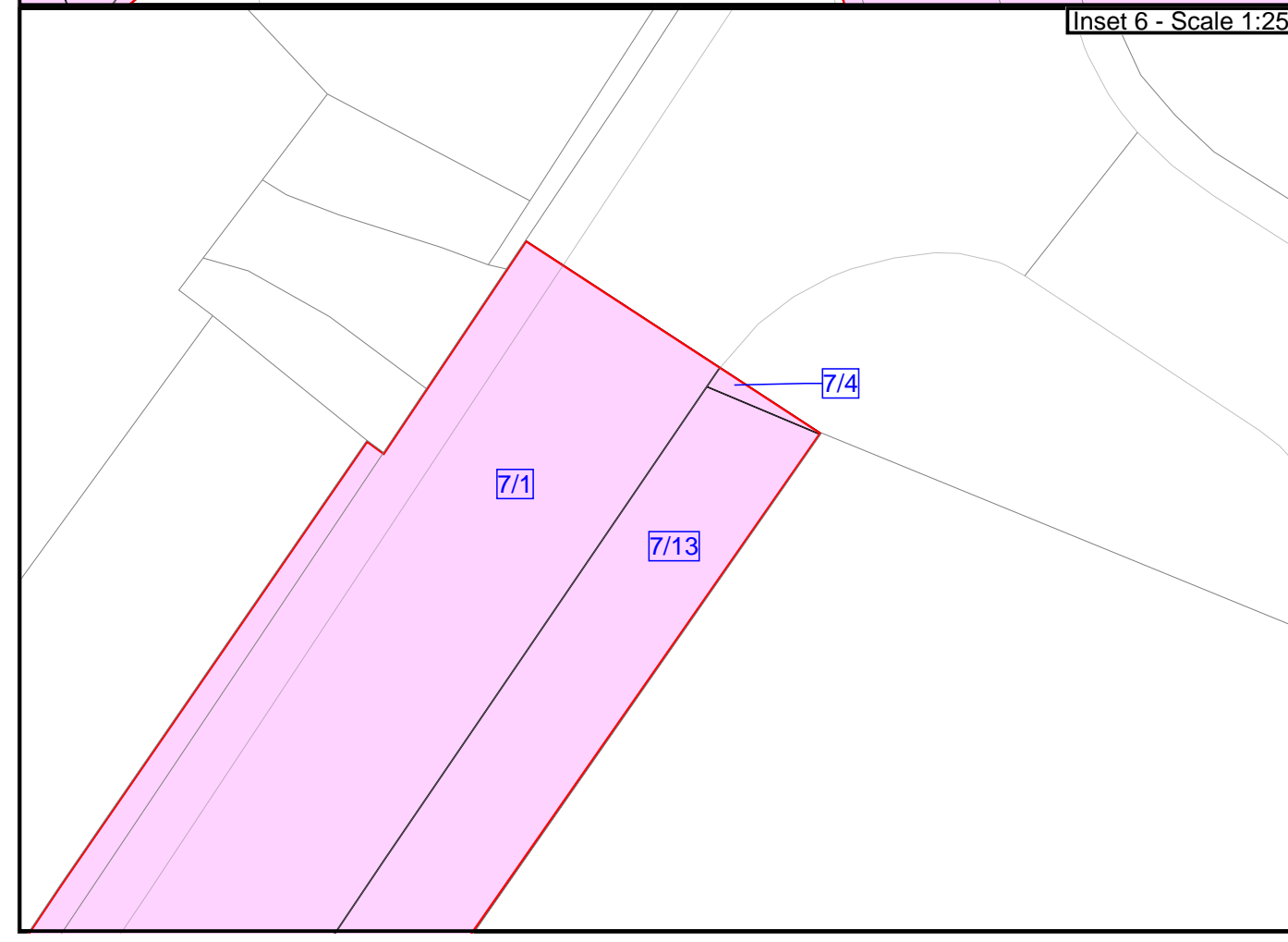
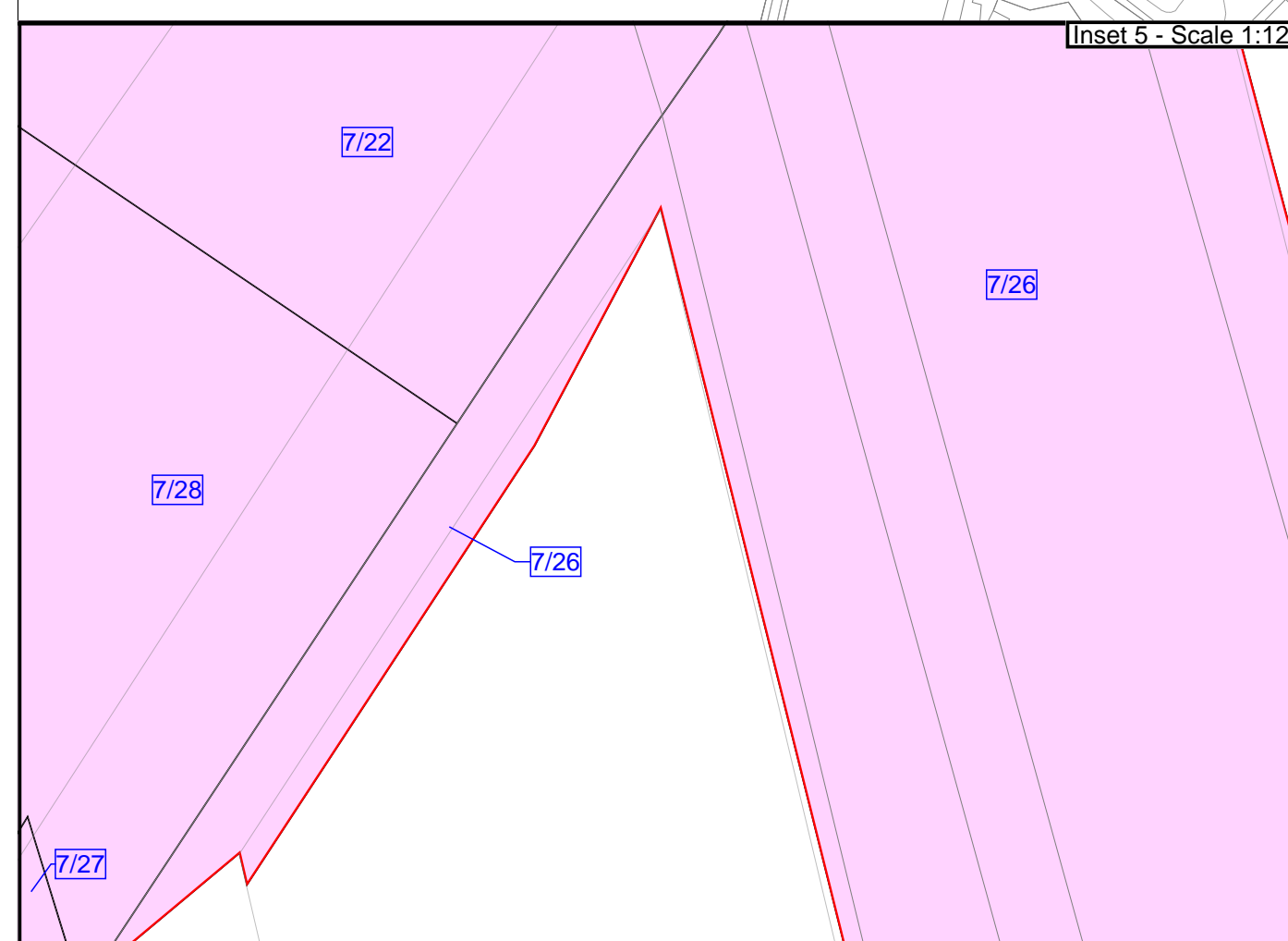
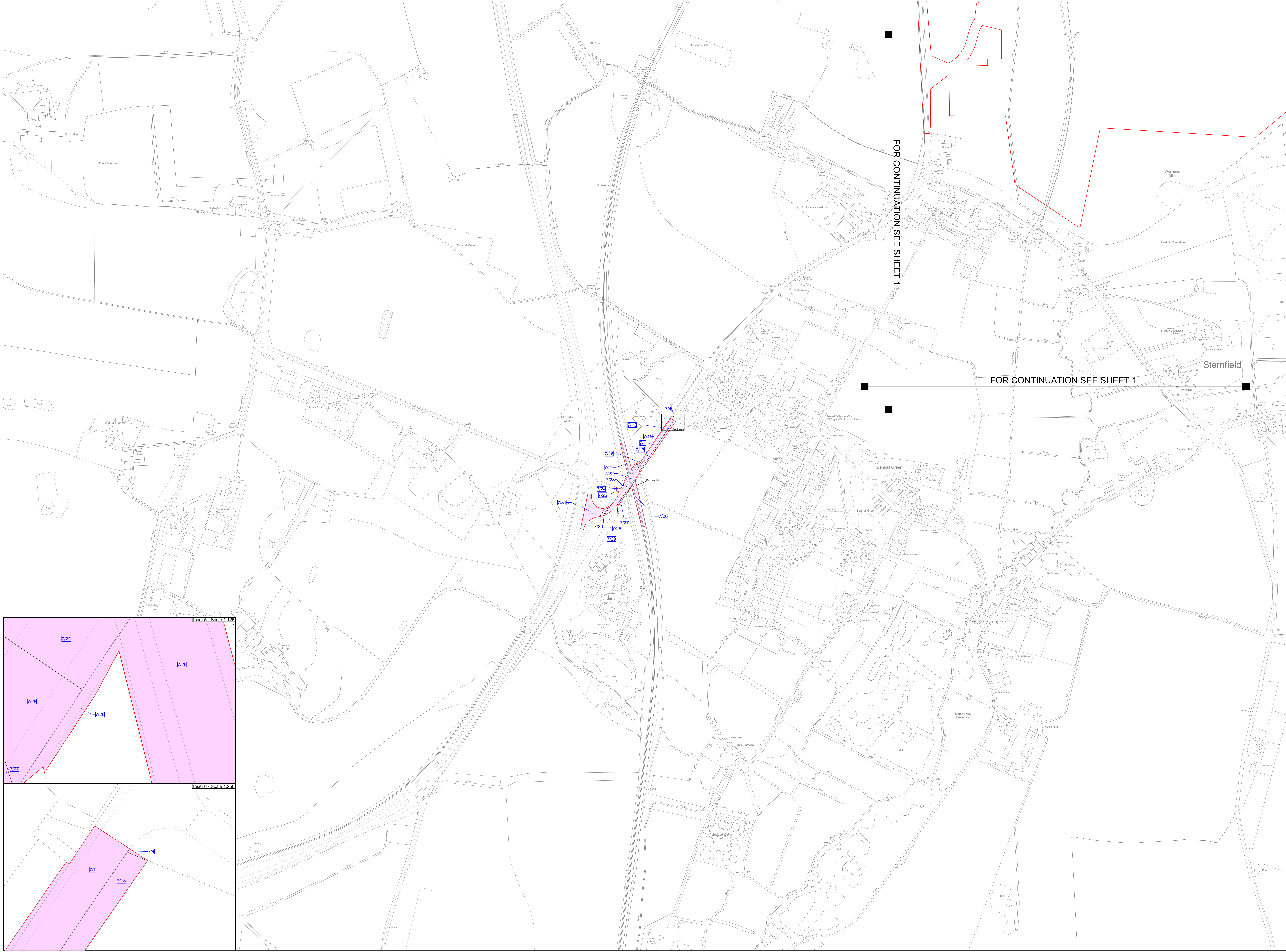

- Notes**
1. This plan is scaled at paper size A0, therefore any prints taken at smaller sizes will affect accuracy of the measurement units and should not be scaled against.
 2. For further information in regard to what the plans are showing, please see 'Guide to the Plans' (Document Ref 2.1)
 3. This plan only shows plots from areas added to the order limits in October 2025

Coordinate System: British National Grid
 Sheet X Centroid Coordinate: 638017 Sheet Y Centroid Coordinate: 261317

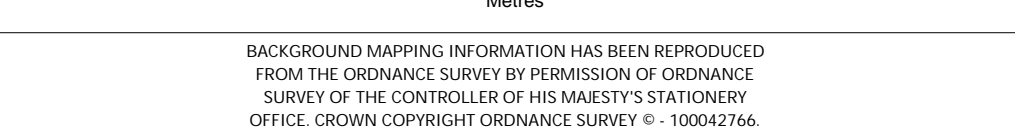

BACKGROUND MAPPING INFORMATION HAS BEEN REPRODUCED FROM THE ORDNANCE SURVEY BY PERMISSION OF ORDNANCE SURVEY OR THE CONTROLLER OF HIS MAJESTY'S STATIONERY OFFICE. DESIGN COPYRIGHT ORDNANCE SURVEY © 1999/2004.

Issue	Date	Remarks	Drawn	Checked	Approved
E	05/02/2026	For Deadline 4	HDA	HKO	SAN
D	07/01/2026	For Deadline 3	HDA	HKO	SAN
C ver 2	21/11/2025	Change Request Version	HDA	ZHU	LJO
C	19/11/2025	For Deadline 1A	HDA	ZHU	LJO
B	04/11/2025	Version 2, Change Request	HDA	ZHU	LJO
A	03/10/2025	For Submission	ZHU	KGA	LJO

Title

THE NATIONAL GRID (SEA LINK) ORDER
 PINS APPLICATION NUMBER: EN020026
 LAND PLANS - SUFFOLK
 REGULATION 5(2)(i)-(iii)
 SHEET 7 OF 7
 IN THE DISTRICT OF
 EAST SUFFOLK DISTRICT COUNCIL

nationalgrid			
Application Number:		EN020026	
National Grid Drawing Reference:		DCO/SLP/PS/0114	
Scale:	Sheet Size:	Sheet:	Issue:
1:2,500	A0	SHEET 7 OF 7	E